

Unpacking

Before using the device, check the device model and ensure that the shipped box includes the following items:

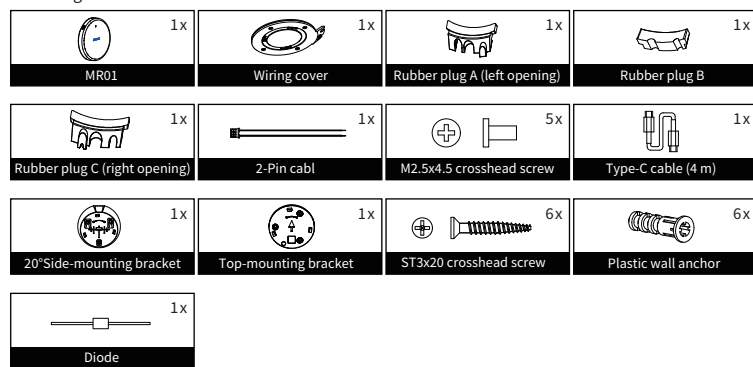

Product Overview

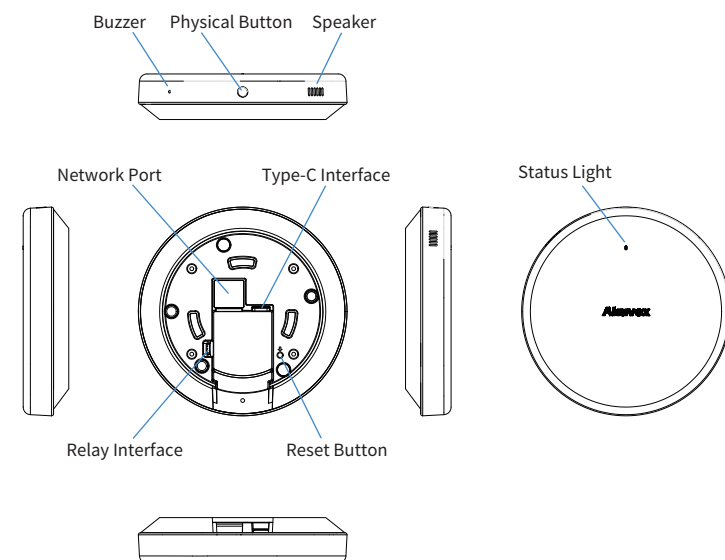

Before You Start

Tools needed

(not included in shipped box)

- Spirit Level
- Crosshead Screwdriver
- Electric Drill

Installation Tips

- Ensure there are no interference objects within a 70 cm radius of the device installation area, such as moving objects, metal objects, or lights.
- For side mounting, no objects higher than 1.5 m should exist within the detection range.
- Do not attach any objects to the surface of the device.
- During installation, ensure the device is level and properly aligned. The angle calibration function can be used on the device web interface under Fall Setting > General Settings.
- The device power cable should be vertical to the ground.

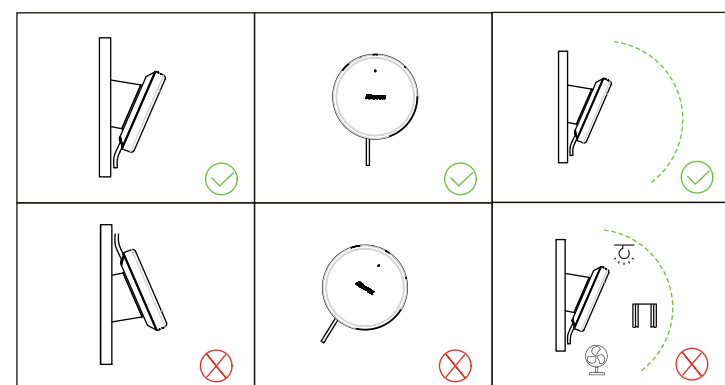

Recommended Usage Range

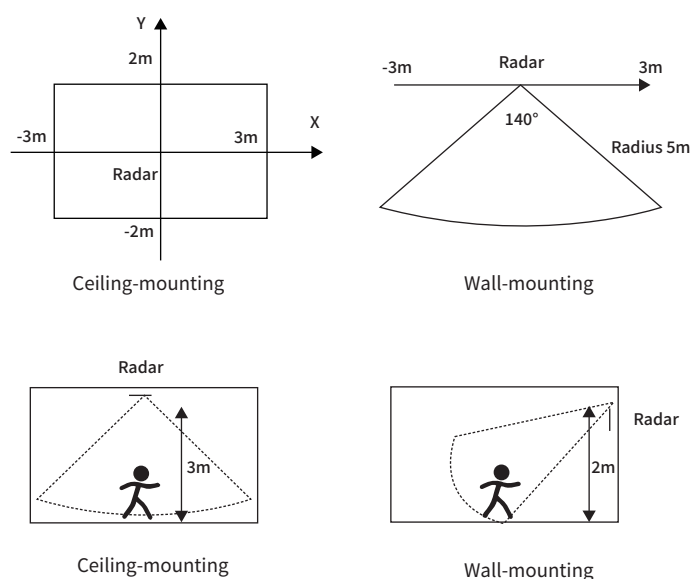

Requirements

1. Place the device away from sunlight and light sources to prevent potential damage.
2. Do not place the device in the high-temperature, and humid environments or in surroundings impacted by magnetic field.
3. Install the device on the flat surface securely to avoid personal injuries and property loss caused by device's falling.
4. Do not use or place the device near heating objects.
5. Please keep device at least 2 meters away from light, and at least 3 meters away from window and door.



Warning!

To ensure safety, avoid touching power cord, power adapter, and device with wet hands, bending or pulling the power cord, damaging any components, and use only qualified power adapter and power cord.

Caution

1. Do not knock device with hard objects.
2. Do not press down hard on the device screen.
3. Do not expose device to chemical products, such as alcohol, acid liquid, disinfectants, and so on.
4. To prevent the device installation from becoming loose, ensure accurate diameters and depths of screw holes. If the screw holes are too large, use glue to secure the screws.
5. Use wet cloth clean device surface softly, and then wipe the surface with dry cloth for cleaning the device.
6. If there is abnormal situation of the device, including uncommon sound and smell, please power off the device and contact Akuvox Technical Team immediately.

Wiring Interface

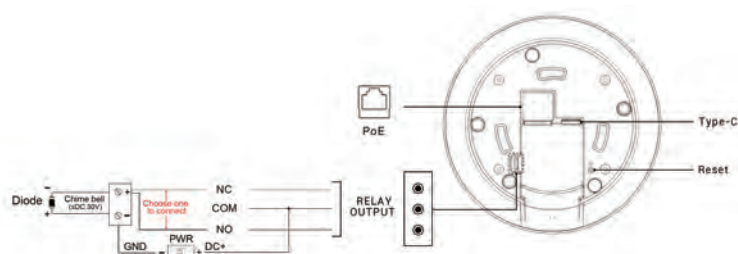

Warning

To protect the device from potential damage caused by over-voltage, it is recommended to wire a diode into the circuit. Connect the anode of the diode to the negative cable of the lock, and connect the cathode of the diode to the positive cable of the lock.

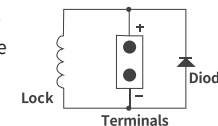

Installation Side Mounting

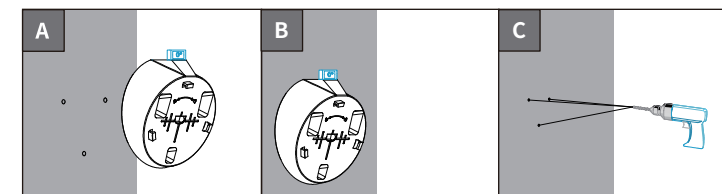

- Place the spirit level on the raised area above the **side-mounting bracket** and ensure it remains level (horizontal angle error $\leq 0.5^\circ$). The bubble vial at the center of the bracket can be used as a reference for verification.
- Position the **side-mounting bracket** at the installation location, ensuring it is flush against the surface. Hold the bracket firmly in place, then use a marker to indicate the centers of the three circular mounting holes (upper and lower) on the wall. The markings should be made as close as possible to the exact center of each hole.
- Remove the **side-mounting bracket**.
- Use a 5 mm drill to make three mounting hole on the marked position.

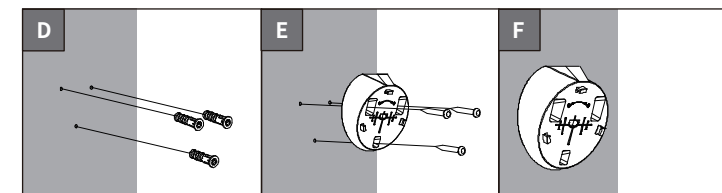

- Insert three **plastic wall anchors** into the holes.
- Fix the **side-mounting bracket** on the wall with three **ST3x20 crosshead screws**, please ensure the bracket against to wall.
- After tightening the bracket, use the spirit level again to verify that the horizontal angle error is within 0.5° . Once confirmed, the **side-mounting bracket** installation is complete.

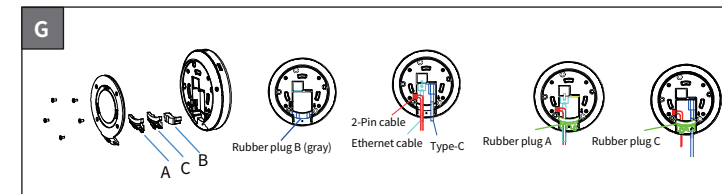

- Take out the main unit, wiring cover, rubber plug A, B, and C, and five M2.5x4.5 crosshead screws from the box.
- Place **rubber plug B** (gray) as shown in the figure.
- Select either **Ethernet cable** or **Type-C cable** for power supply according to the actual installation requirements (choose one). Confirm whether the **2-Pin cable** is required based on the installation needs (refer to Wiring Interface section for detailed wiring instructions).
- After arranging the cables according to the positions shown in the diagram, insert **rubber plug A** or **C** to clamp the cable bundle. Choose rubber plug A or rubber plug C according to the installation type:
 - Use **rubber plug A** (left opening) when using an Ethernet cable.
 - Use **rubber plug C** (right opening) when using a Type-C cable.
- Secure the **wiring cover** to the device using the five **M2.5x4.5 crosshead screws**.

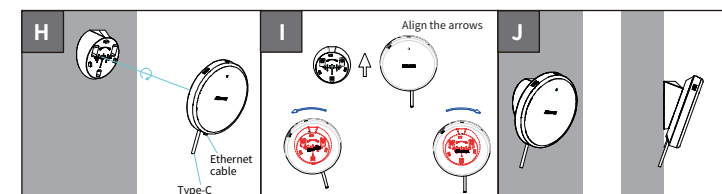

- Rotate the main unit counterclockwise slightly, then place it tightly against the mounting box.
- Follow the arrow indication on the mounting box, rotate the unit clockwise to install it.
- Ensure that the Ethernet cable/Type-C cable is not pinched during installation.

- Rotate the device counterclockwise by 15° until the bracket hooks slide into the slots.
- Rotate the device clockwise until you hear a "click," indicating it is securely locked in place.
- Check whether the main unit and the mounting box are flush with the wall. Use a level to measure them using the same method described above.
- Ensure that all connections are secure. Power on the device and verify that it operates normally. The installation is now complete.

Top Mounting

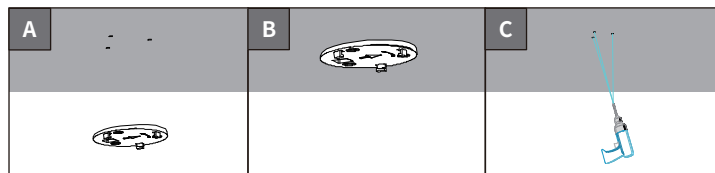

- On the mounting position, mount the installation bracket close to the ceiling, and ensure the arrow is perpendicular to the wall.
- Position the **top-mounting bracket** at the installation location, ensuring it is flush against the ceiling. Hold the bracket firmly in place, then use a marker to indicate the centers of the three circular mounting holes on the wall. The markings should be made as close as possible to the exact center of each hole.
- Remove the **top-mounting bracket**.
- Use a 5 mm drill to make three mounting hole on the marked position.

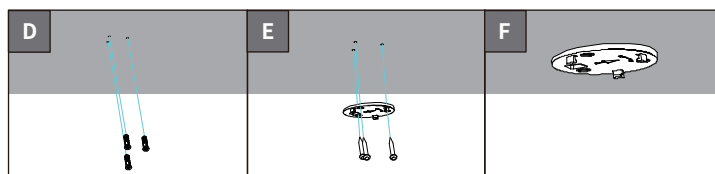

- Insert three **plastic wall anchors** into the holes.
- Fix the **top-mounting bracket** on the wall with three **ST3x10 crosshead screws**, please ensure the bracket against to wall.
- After tightening the bracket, use the spirit level again to verify that the horizontal angle error is within 0.5°. Once confirmed, the **top-mounting bracket** installation is complete.

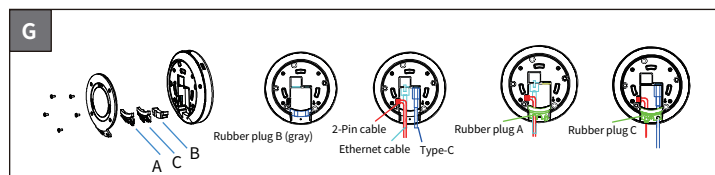

- Take out the main unit, wiring cover, rubber plug A, B, and C, and five M2.5x4.5 crosshead screws from the box.
- Place **rubber plug B** (gray) as shown in the figure.
- Select either **Ethernet cable** or **Type-C cable** for power supply according to the actual installation requirements (choose one). Confirm whether the **2-Pin cable** is required based on the installation needs (refer to Wiring Interface section for detailed wiring instructions).
- After arranging the cables according to the positions shown in the diagram, insert **rubber plug A** or **C** to clamp the cable bundle. Choose rubber plug A or rubber plug C according to the installation type:
 - Use **rubber plug A** (left opening) when using an Ethernet cable.
 - Use **rubber plug C** (right opening) when using a Type-C cable.
- Secure the **wiring cover** to the device using the five **M2.5x4.5 crosshead screws**.

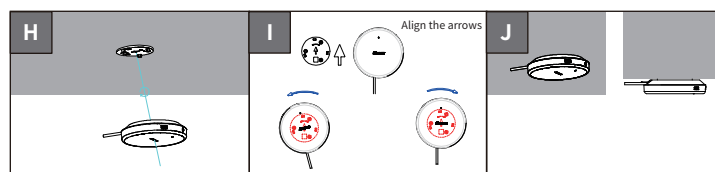

- Rotate the main unit counterclockwise slightly, then place it tightly against the mounting box.
- Follow the arrow indication on the mounting box, rotate the unit clockwise to install it.
- Ensure that the Ethernet cable/Type-C cable is not pinched during installation.
- Rotate the device counterclockwise by 15° until the bracket hooks slide into the slots.
- Rotate the device clockwise until you hear a "click," indicating it is securely locked in place.

- Check whether the main unit and the mounting box are flush with the ceiling. Use a level to measure them.
- Ensure that all connections are secure. Power on the device and verify that it operates normally. The installation is now complete.

LED Status Information

LED Status		Description
Green	Always on	Normal status
	Fast blinking	Network error
Red	Always on	Startup
		Upgrading
	Fast blinking	Fall alarm
		Offset angle Exceeds 5° for side mounting
Slow blinking	Fall confirmation	
	Reset	

Note: For more LED settings, please check in **Device > LED Setting** of MR01 Web UI.

Operation Tips

- Press and hold **Physical button** to obtain IP address, network is working properly if the device announce IP address. If no IP address is obtained, MR01 will announce "IP 0.0.0.0".
- Long press **Reset Button** for 3 seconds to reset the device. Configure the Network settings under Network > Basic on the web interface:
 - If PoE is not used, a Wi-Fi connection is required. Configure the Wi-Fi settings.
 - Connect smartphone to the device's Wi-Fi AP to automatically launch the configuration page in your browser for login and setup.
 - The Wi-Fi AP is on by default. Long-press the button for 3s to turn it on/off.
 - The Wi-Fi AP SSID is configured as the Wi-Fi name, which defaults to "MR01_" followed by the last four digits of the MAC address.



NOTICE:
Quick guide can be viewed on Global Visions website.



GLOBAL VISIONS INC.
877-725-8869
www.globalvisionsinc.com

Disclaimer

This document provides specifications and information regarding the Akuvox MR01 (hereinafter referred to as the "Product"). The information in this document is subject to change without prior notice due to continuous product enhancement. Customers shall verify with Akuvox sales representatives or authorized distributors that this document represents the most current version prior to use.

1. Information and Rights Statement

The information contained in this document is provided solely to illustrate examples of the Product' s operation and application. It does not constitute a warranty, whether express or implied, regarding the intellectual property rights of Akuvox or any third party, nor shall it be construed as granting any license.

Customers shall assume full responsibility for any system or equipment designs based on this information. Akuvox shall not be liable for any damages or losses incurred by the customer or third parties arising from the use of such information.

2. Restrictions on High-Risk Applications

The Product is neither designed nor intended for use in applications requiring extraordinary reliability, including but not limited to medical devices, aerospace systems, mass transit, traffic signaling, combustion control, nuclear power facilities, or other safety-critical systems. No warranty is provided for such applications.

This Product is a supplementary monitoring device and shall not be used as the sole or primary substitute for manual inspection, professional care, or emergency services (such as ambulance or police assistance). If customers use the Product for such purposes without appropriate human supervision and rely solely on the information it provides, resulting in failure to detect incidents such as falls or injuries in a timely manner, Akuvox shall not be liable for any resulting damages, losses, or consequences.

3. Safety Design Obligations

Despite Akuvox' s commitment to product quality and reliability, electronic devices are inherently subject to malfunction or failure. Customers shall be responsible for implementing comprehensive safety measures and redundancies in end-user products incorporating the Product to prevent bodily injury, loss of life, or property damage caused by potential malfunction or improper operation.

4. Military, Export Control, and Prohibited Use

Customers shall not use this Product or the technical information contained in this document for the development of weapons of mass destruction, military applications, or any related military purposes. The Product shall not be used in connection with nuclear explosive devices, unsafe nuclear fuel cycle activities, or activities that support human rights violations. Customers shall ensure that the Product and its associated technical information are not used in or incorporated into any equipment or systems whose manufacture, use, or sale is prohibited by applicable laws or regulations in relevant jurisdictions.

5. Environmental Compliance

Customers shall consult Akuvox sales representatives for information regarding the environmental compatibility of the Product. Customers shall be responsible for investigating and complying with all applicable environmental protection laws and regulations. Akuvox shall not be liable for any damages resulting from a customer' s failure to comply with such laws or regulations.

6. Responsibility of Resale

If the Product is resold or otherwise transferred by a customer and is subsequently used in violation of the provisions set forth herein, such customer shall bear full responsibility for any resulting damages or losses and shall indemnify and compensate any affected parties accordingly.



YS01000040