

iClassic[®] cUL

Datasheet



The following rights are reserved:

- Any unannounced changes to the functionality or appearance of this product will void the warranty.
- Use of this product in any environment or in any manner not specified herein will also void the warranty.

NE

iClassic® cUL

Recongnized for its reliability, rubost and high technologic. With this solution, the opening process is by RFID (Mifare) proximity devi-ces. Totally wire free and with low energy consumption. Setup all access through our software.



technical sheet

Material	Stainless Steel
Certification	UL & cUL
Opening Method	Card, WiFi [opt], Bluetooth [opt], APP [opt], Mechanical Key
Identification Time	<1.0S
Communication	Bluetooth 4.1 [opt], Mifare [13,56MHz]
Cylinder	ANSI half round cylinder
Compatibility with Locks	ANSI lock
Emergency Power	N/A
Emergency Opening	Mechanical Key
Voltage	DC 6v [AAA*4]
Max. Power	6V-MAX
Battery Life	~ 12 months, supports ~ 5,000 opening & closing operations
Leds	Green, Red
Low Battery Alarm	3 bips, in APP [opt]
Consumption	<300mA
Static Consumption	12µA
Time Open	7s
Number of Openings	~5,000 Openings (1Year)
Software	iTEC Hybrid, iTEC onAccess [Web] [opt], iTEC onAccess-Pro [Web] [opt], iTEC onHos-pitality [Web] [opt]
APP's	iTEC onAccess [opt]
Compatibility	iOS 8/Android 5 or above
Stand Alone	No
IP	IP44
Weight	3,20 Kg
Humidity Resistance	30%-95%
Temp. of Operation	-20°C~+ 65°C
Nº of Cards	200
Nº of Codes	N/A
Nº of Autodefined Codes	N/A
Nº of Fingerprints	N/A
User Levels	Yes
Managment Code	N/A
Door Thickness	45mm ~110mm

mortises

Ansi Solenoid® cUL®

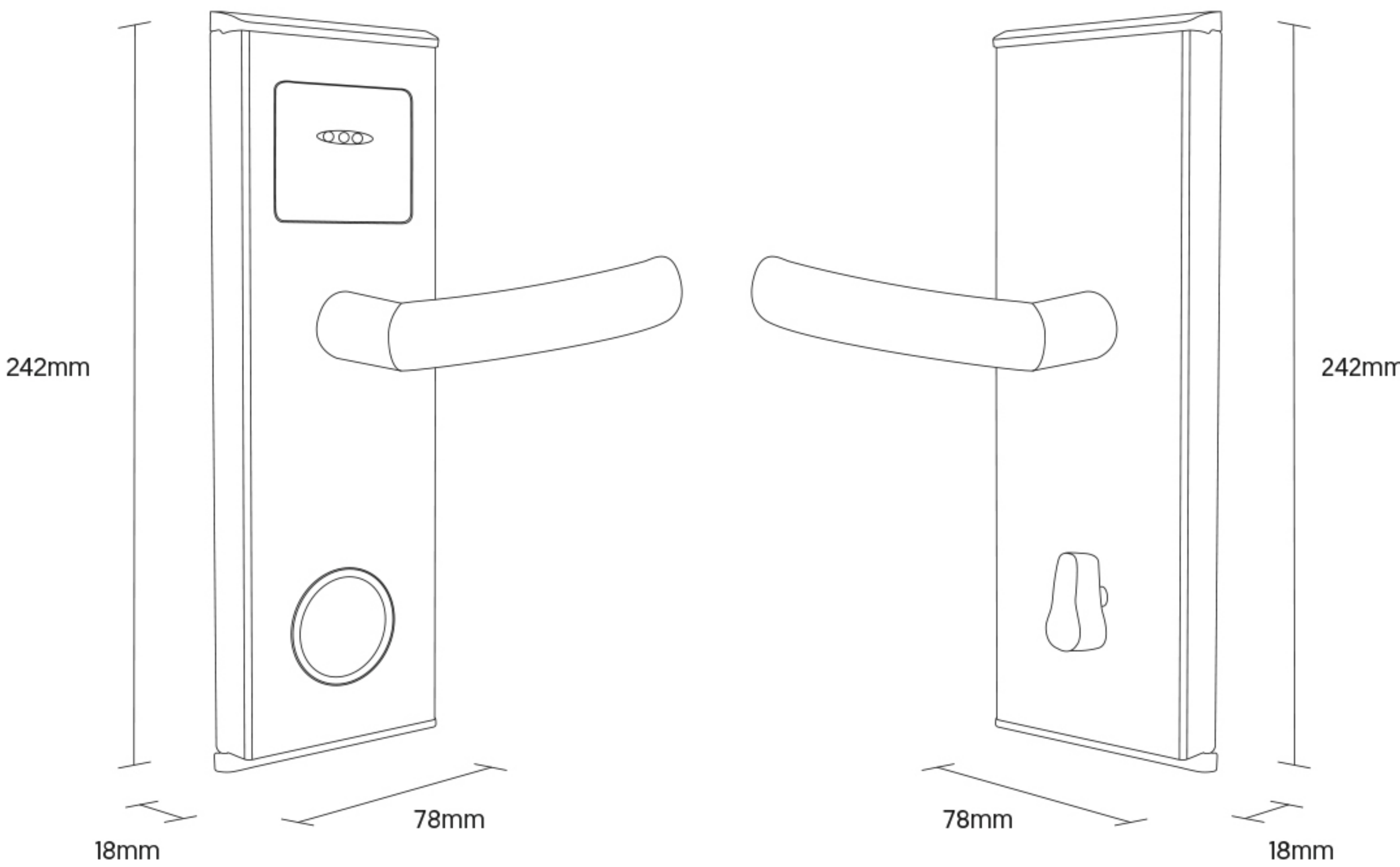
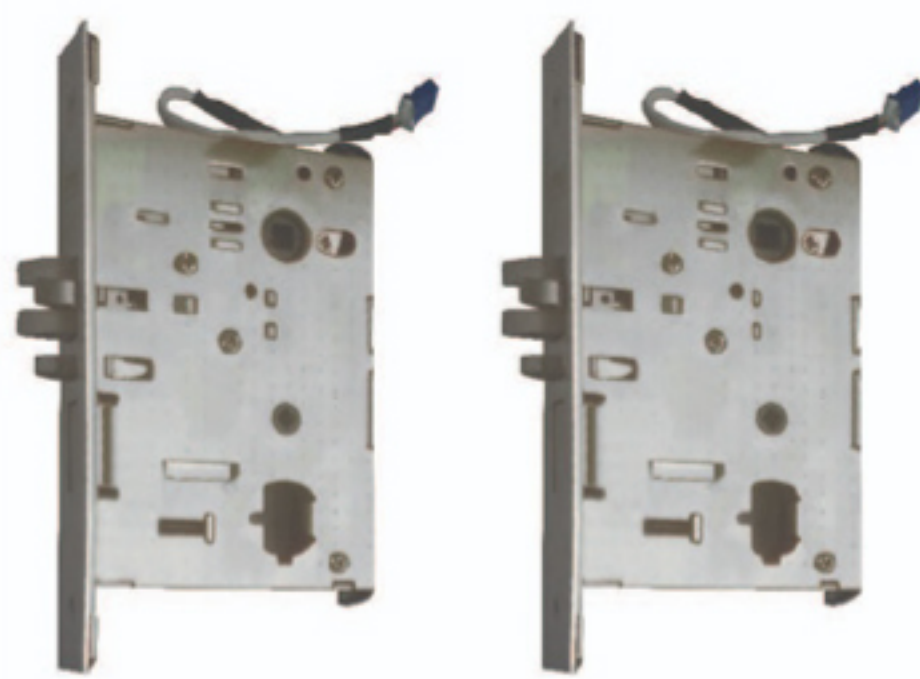



Web: GlobalVisionsInc.com
Email: sales@GlobalVisionsInc.com
Phone: 877-725-8869